

MATERIALS	
BODY	PASSIVATED STAINLESS STEEL
CONTACT	GOLD PLATED
INSULATOR	PEI / PTFE
ELECTRICAL & ENVIRONMENTAL CHARACTERISTICS	
IMPEDANCE	50 OHMS
INSULATION RESISTANCE	5000 MΩ
OPERATING FREQUENCY	18 GHz
DIELECTRIC WITHSTANDING VOLTAGE	1500 Vrms
VSWR MAX	1.15:1
INSERTION LOSS MAX	.05 √ Freq. GHz
OPERATING TEMPERATURE	-55 to +165 C°
VOLTAGE RATING	1000 VOLTS
INTERFACE	MIL-STD-348
VIBRATION	MIL-STD-202 METHOD 204, CONDITION A
CORROSION	MIL-STD-202 METHOD 101, CONDITION B

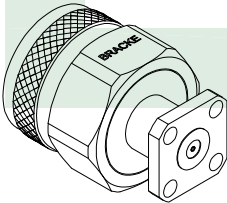

3/4" HEX

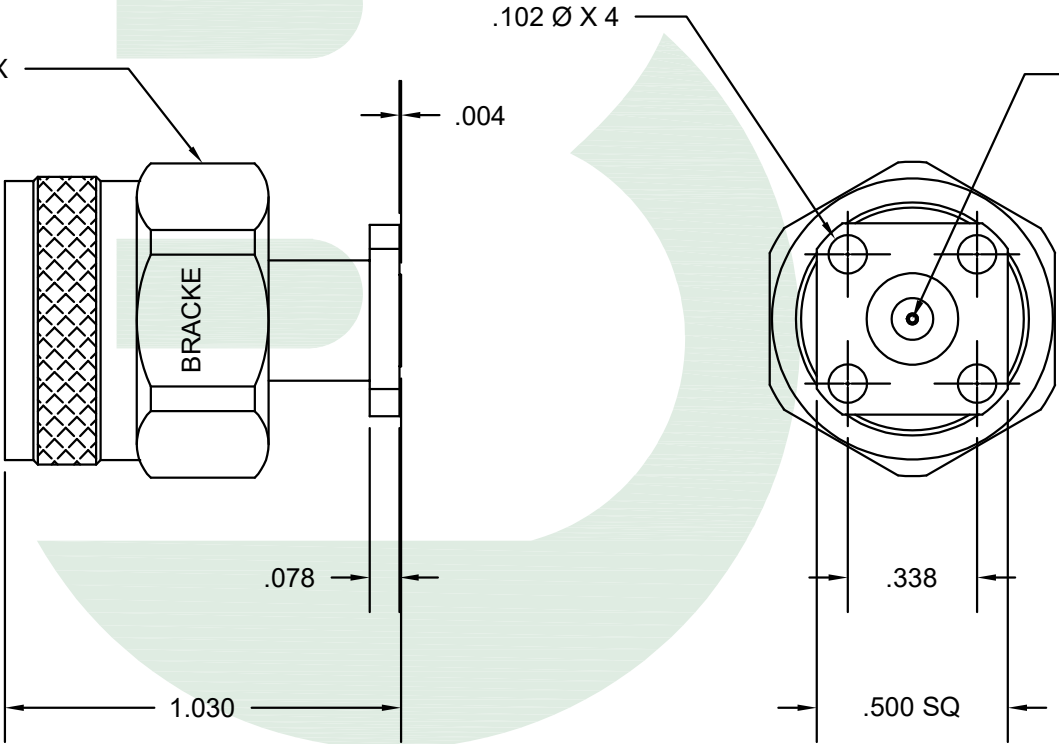

ACCEPTS
.020 Ø X .098 PIN
LENGTH



BRACKE
Bracke Manufacturing, LLC

Scale 1:1



Bracke Manufacturing, LLC
PO Box 12319
Newport Beach, Ca 92658
Phone (949)756-1600 / Fax (949) 756-1601
sales@brackemfg.com / www.brackemfg.com

Part Number	
BM61652	
Produced By	Checked By
002	014

Description	
N Male 4 Hole Panel Mount, .500" Sq. Flange Accepts .020" X .098" Pin [Field Replaceable Connector]	
Notes	
<ul style="list-style-type: none"> Bracke Manufacturing, LLC reserves the right to change any specifications at any time in its sole discretion without notice. The depiction above was produced by and is the sole property of Bracke Manufacturing, LLC and may not be copied or reproduced in any manner without Bracke's prior written consent. 	
©2025 Bracke Manufacturing, LLC	

CAGE / NAGE	
6LOW2	
Scale	Unit
2:1	Inches
Date	Revision
8/13/2025	A-01